

## Branding Hotel Lock suppliers china PY-8011-6

supplier: [Multi-language Attendance machine wholesale](#), [Keyless door lock china](#), [rfid access control system](#)

### Smart Card Basic Function

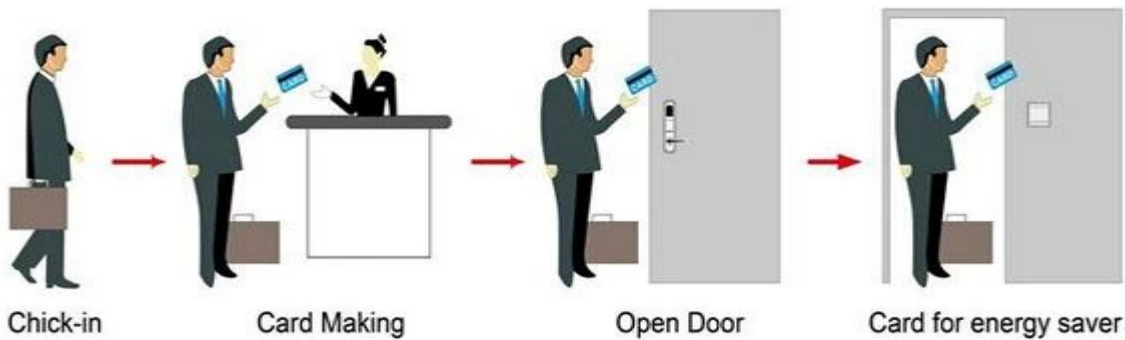

### Smart Card Extensive Function



Card Type ID, TEMIC, MIFARE®

Lock Material Front&back&handle 304 stainless steel

Card Life 10 years

Inductive distance  $\leq 5\text{cm}$

Power Supply DC 6V , 4pcs of AA alkaline batteries

Static Power consumption  $< 30\ \mu\text{A}$

Dynamic power consumption  $< 200\ \text{mA}$

Single operation 0.8 seconds

Card read time  $< 0.1\text{s}$

Install door thickness 32-60 mm

Facial color Can be customerized

package includes complete lock,software and demo video

Language support Chinese, English, Portuguese,Turkish,Russian

Warranty: 1 year warranty

Service OEM or ODM

Compatible network Windows XP / 2000 / 2003/2007

Technology advanced hassel USB technology

Model PY-8181

## HOTEL LOCK SYSTEM ONE-CARD-PASS



1. [Hotel Lock suppliers china](#) Lock (qty = guest room)---For open the door
2. Encoder (1pcs/hotel ) ---For issuing all kinds of cards
3. Switch (qty = guest room)---To get the power
4. Cards (qty = 3 times of guest room)----For open the lock
5. Data collector (1pcs/hotel, optional )----For getting the time and times of the entrance information from the lock
6. Self developed software ( free of charge)----For setting the program the whole system.

**Our careful and fabulous workers:**



**Our happy and contented customers:**



**Our fast and prompt delivery:**





Our confidence and success in exhibition:



## Accessories list reminder:



**1**  
Door Lock  
Software



**2**  
RF Card  
Reader



**3**  
Data Collector



**4**  
RF Card



**5**  
Gain Power  
Switch

## Please confirm door opening direction as below 4 types:

<b>right (push)</b>	<b>right (pull)</b>	<b>left (push)</b>	<b>left (pull)</b>

Welcome your inquiry