

# Keyless Smart Card System

## Smart Card Basic Function

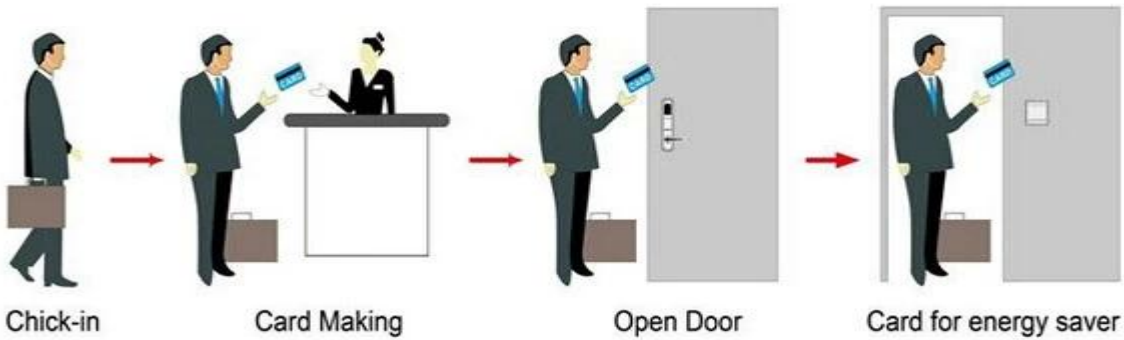

## Smart Card Extensive Function



Material: TEMIC, MIFARE®  
Material & Capacity: 304  
Capacity: 10 bits  
Voltage:  $\leq 5$  V  
Power: DC 6V, 4pcs AA  
Current:  $UA < 30$   
Frequency:  $< 200$  mA  
Response time: 0.8 s  
Access time:  $< 0.1$  s  
Temperature: 32-60 °C  
Customized: customerized  
Software: Windows XP / 2000 / 2003/2007  
Interface: hasel USB

Model: PY-8505



PRODUCT DISPLAY



**HOTEL LOCK SYSTEM**  
**ONE-CARD-PASS**



1. XXXXXXXXXXXXXXXXXXXXXXXXXXXXXXXXXX XXXX (XXXX = XXXX)---XXXXXXXXXXXXXXXXXXXX
2. XXXXXXXXXXXXXXX (1pcs/XXXX)---XXXXXXXXXXXXXXXXXXXX
3. XXXX (XXXX = XXXX)---XXXXXXXXXXXX
4. XXXX (XXXX = 3 XXXXXXXXXXXXXXX)---XXXXXXXXXXXX
5. XXXXXXXXXXXXXXX (1pcs/XXXX XXXXXXX)---XX
6. XXXXXXXXXXXXXXX (XX)---XXXXXXXXXXXXXXXXXXXX

XXXXXXXXXXXXXXXXXXXXXXXXXXXXXXXXXXXX:



XXXXXXXXXXXXXXXXXXXXXXXXXXXXXXXXXXXX:



XXXXXXXXXXXXXXXXXXXXXXXXXXXX XXXXX XXXXX:



## Accessories list reminder:



1  
Door Lock  
Software



2  
RF Card  
Reader



3  
Data Collector



4  
RF Card



5  
Gain Power  
Switch

## Please confirm door opening direction as below 4 types:

<p>Indoor</p> <p>Outdoor</p>	<p>Indoor</p> <p>Outdoor</p>	<p>Indoor</p> <p>Outdoor</p>	<p>Indoor</p> <p>Outdoor</p>
right (push)	right (pull)	left (push)	left (pull)

Welcome your inquiry